

MODEL 6HVP48 THRU 12HVP504

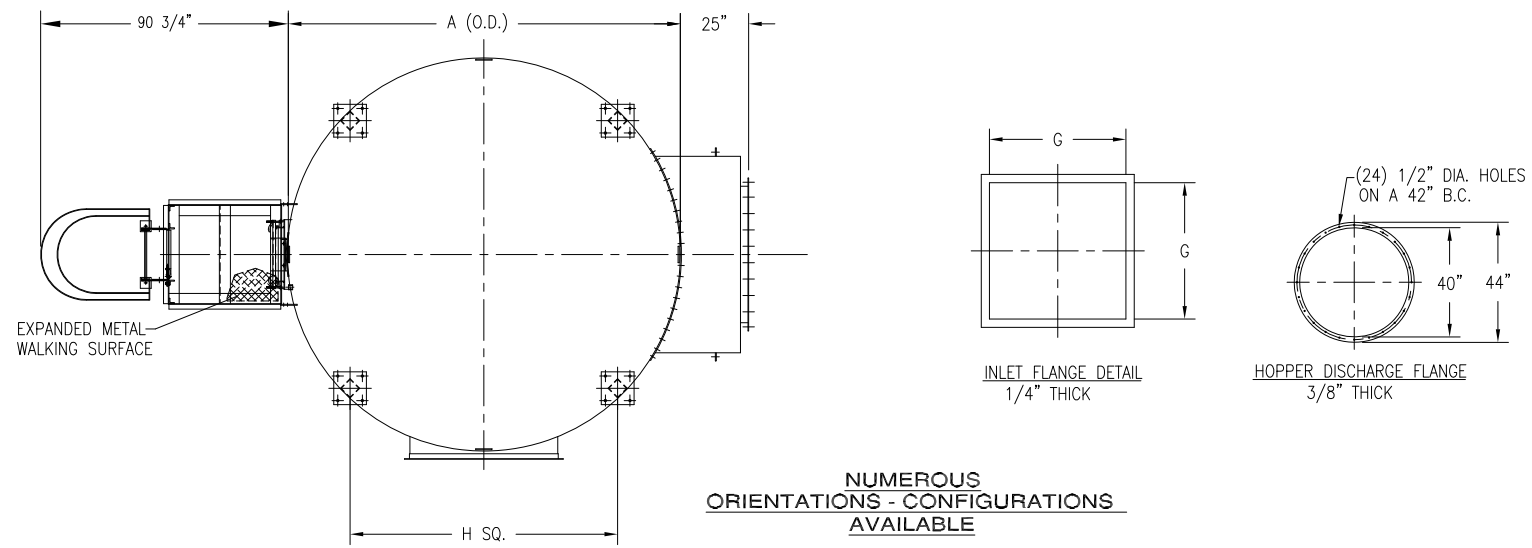

NUMEROUS ORIENTATIONS - CONFIGURATIONS AVAILABLE

MODEL NUMBER	FILTER MEDIA (SQ. FT.)	QUAN. OF BAGS	BAG LENGTH (IN FT.)	MAT'L OF CONST.	DIMENSIONS (INCHES)								PD PUMP H.P.	# OF EXPLOSION VENTS	EST. INSTALLED WT./LBS.	
					A	B	C	D	E	F	G	H				J
6HVP48	348	48	6	12 GA.	60	281 9/16	95 1/4	75 1/4	17 11/16	164 15/16	16	40 1/8	1"	3 HP	1 *	4884
8HVP48	464		8			329 9/16	119 1/4	99 1/4		187 15/16	18				1 *	5468
10HVP48	581		10			377 9/16	143 1/4	123 1/4		210 15/16	20				1 *	6054
6HVP80	580	80	6	12 GA.	72	293 9/16	95 1/4	75 1/4	28 1/16	173 5/16	20	48 5/8	1"	3 HP	1	5408
8HVP80	774		8			341 9/16	119 1/4	99 1/4		196 5/16	22				1	6097
10HVP80	968		10			389 9/16	143 1/4	123 1/4		219 5/16	24				1	6790
8HVP112	1084	112	8	10 GA.	84	353 9/16	119 1/4	99 1/4	38 1/2	204 1/4	27	57 1/16	1"	3 HP	1	7461
10HVP112	1355		10			401 9/16	143 1/4	123 1/4		226 3/4	30				1	8384
12HVP112	1626		12			425 9/16	143 1/4	147 1/4		249 1/4	33				1	9056
8HVP152	1471	152	8	10 GA.	96	365 9/16	119 1/4	99 1/4	48 7/8	213 1/8	30	65 9/16	1-1/2"	3 HP	1	8506
10HVP152	1839		10			413 9/16	143 1/4	123 1/4		235 5/8	33				2	9612
12HVP152	2207		12			437 9/16	143 1/4	147 1/4		258 1/8	36				2	10382
8HVP200	1936	200	8	10 GA.	108	377 9/16	119 1/4	99 1/4	59 1/4	222	33	72 9/16	1-1/2"	5 HP	2	10324
10HVP200	2420		10			425 9/16	143 1/4	123 1/4		243 1/2	38				2	11354
12HVP200	2904		12			449 9/16	143 1/4	147 1/4		265 1/2	42				2	12263
8HVP256	2478	256	8	10 GA.	120	389 9/16	119 1/4	99 1/4	69 11/16	229 15/16	38	81 1/16	1-1/2"	5 HP	2	11485
10HVP256	3097		10			437 9/16	143 1/4	123 1/4		251 15/16	42				2	12856
12HVP256	3717		12			461 9/16	143 1/4	147 1/4		273 15/16	46				3	13858
8HVP312	3020	312	8	10 GA.	132	401 9/16	119 1/4	99 1/4	80 1/16	238 5/16	42	89 9/16	2"	7.5 HP	2	12908
10HVP312	3775		10			449 9/16	143 1/4	123 1/4		260 5/16	46				3	14406
12HVP312	4530		12			473 9/16	143 1/4	147 1/4		282 5/16	50				3	15565
8HVP368	3562	368	8	10 GA.	144	413 9/16	119 1/4	99 1/4	90 7/16	246 11/16	46	98 1/16	2"	7.5 HP	3	14275
10HVP368	4452		10			461 9/16	143 1/4	123 1/4		268 11/16	50				3	15932
12HVP368	5343		12			485 9/16	143 1/4	147 1/4		290 11/16	54				4	17216
8HVP432	4182	432	8	3/16" R	156	425 9/16	119 1/4	99 1/4	100 13/16	256 1/16	48	106 7/16	2"	10 HP	3	18219
10HVP432	5227		10			473 9/16	143 1/4	123 1/4		277 1/16	54				4	20369
12HVP432	6273		12			497 9/16	143 1/4	147 1/4		298 1/16	60				4	22120
8HVP504	4879	504	8	3/16" R	168	437 9/16	119 1/4	99 1/4	111 1/4	263 1/2	54	114 15/16	2"	10 HP	4	20028
10HVP504	6098		10			485 9/16	143 1/4	123 1/4		284 1/2	60				4	22446
12HVP504	7318		12			509 9/16	143 1/4	147 1/4		306 1/2	64				5	24252

* 24" SQUARE EXPLOSION VENT(S) ON HVP-48 MODELS

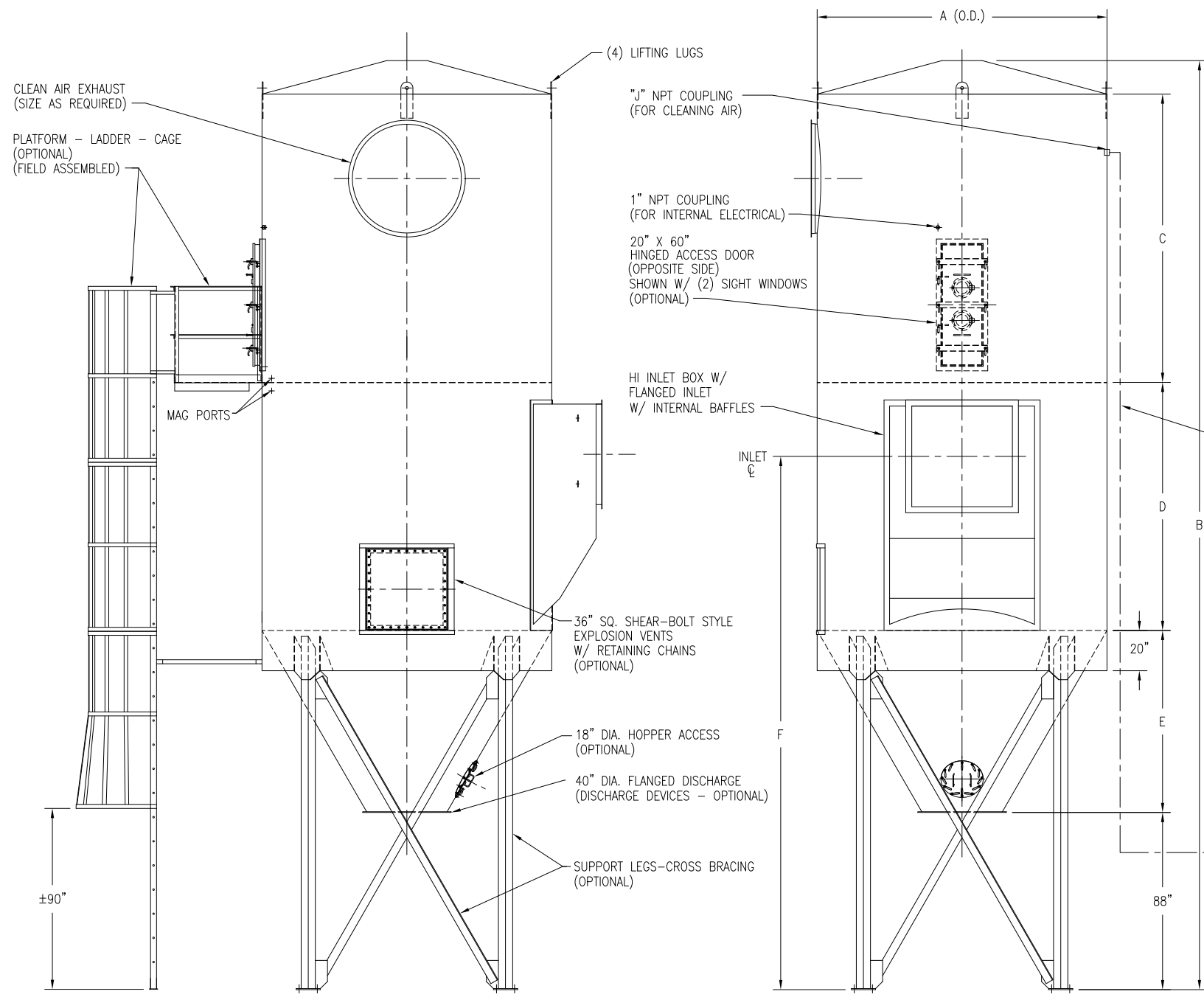

CLEANING AIR PIPE - "J" DIA. (SUPPLIED BY CUSTOMER)

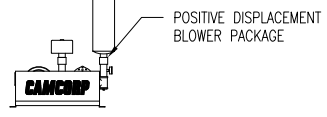
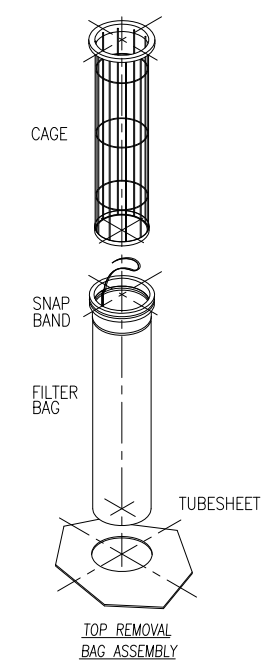

STANDARD FEATURES

1. ALL WELDED HEAVY-DUTY CONSTRUCTION
2. PRESSURE/VACUUM RATING: +/-20"W.C.
3. STANDARD MATERIALS OF CONSTRUCTION: CARBON STEEL, STAINLESS STEEL, ALUMINUM
4. PAINT IS STANDARD WHITE OR ENVIROGREEN INDUSTRIAL ENAMEL
5. STANDARD NUMBER OF EXPLOSION VENTS PROVIDE A 65 : 1 VENT RATIO
6. 1/2 HP MOTOR ROTATES INTERNAL CLEANING MECHANISM

OPTIONAL FEATURES

1. INTERMEDIATE SERVICE PLATFORMS
2. EXPLOSION VENTING / RATIOS
3. EXPLOSION-PROOF ELECTRICALS
4. HIGHER PRESSURE/VACUUM RATING
5. BIN VENT STYLE

REV	DRAWING STATUS	BY	DATE
9732 PFLUMM, LENEXA, KS 66215 PHONE: 913-831-0740 FAX: 913-831-9271			
This drawing and the solutions/designs are the property of CAMCORP, Inc. and are furnished only for informational purposes on a confidential basis. Reproduction, publishing, or other disclosures are on a "NEED TO KNOW" basis only. Any other reproduction requires written authorization by a corporate officer.			
TITLE: HVP (HIGH VOLUME PULSE) DUST COLLECTOR WITH HI-ENTRY INLET			
DATE:	DRAWN:	DRAWING NUMBER:	REVISION:
9/29/06	CK	HVP-HI INLET	